

7 = chair a letter = color of desk
 = wall (ex: y, b)
 15 = brown chair long = long desk

Pre-Show:

SL Wings

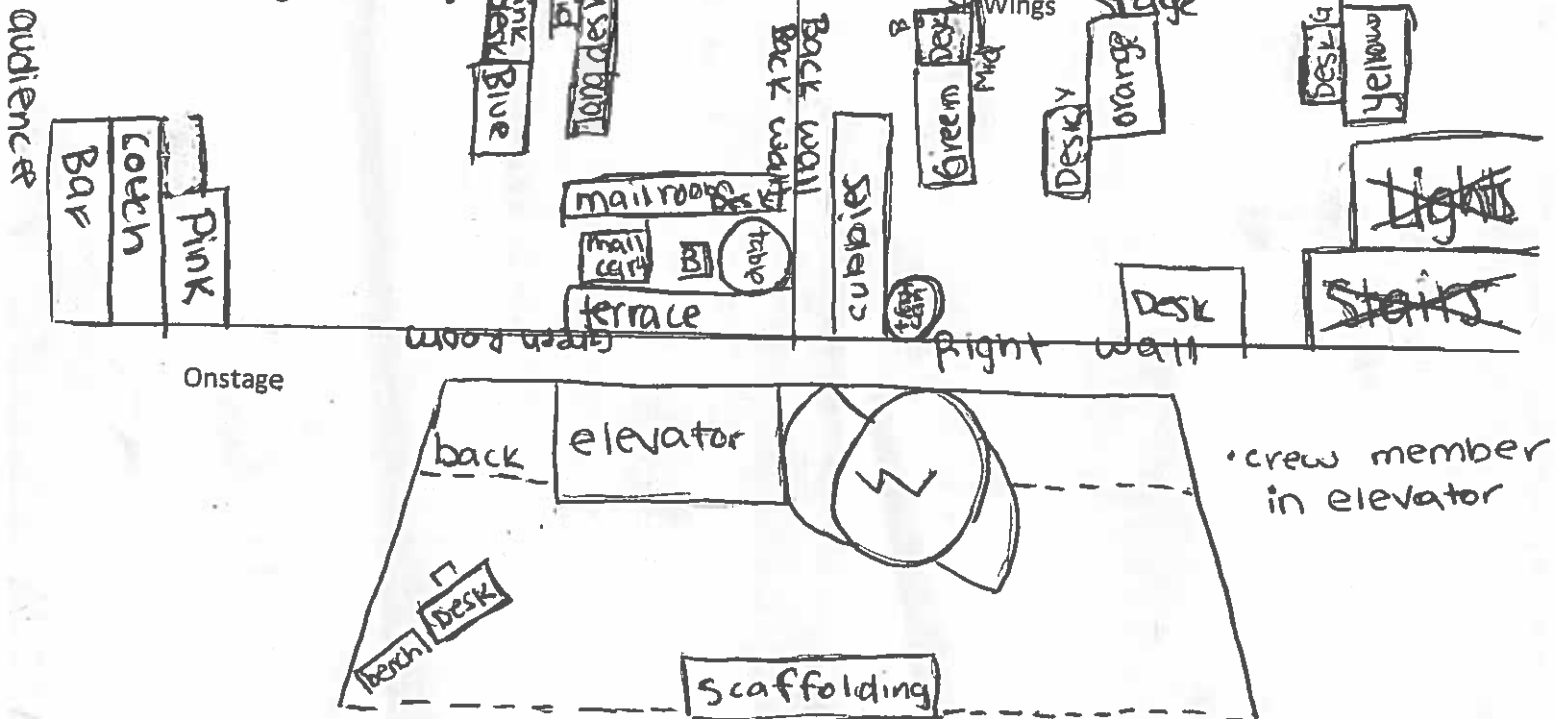

Red Curtain Opens- Finch's first ♪ "How to, How to succeed." ♪
Strike: Scaffolding, pre-set pink wall with desk

rest of scene-same as pre-set

Cast strikes desk and bench (bench goes out R)

Curtain closes: Biggley- "Damn damn coal-burning dithering ding ding ding."
Set: Three walls. Six (6) feet.

Set: Three walls SL w/ desks

:Two walls SR w/ desks

: 9 desks

Back Traveler Closes

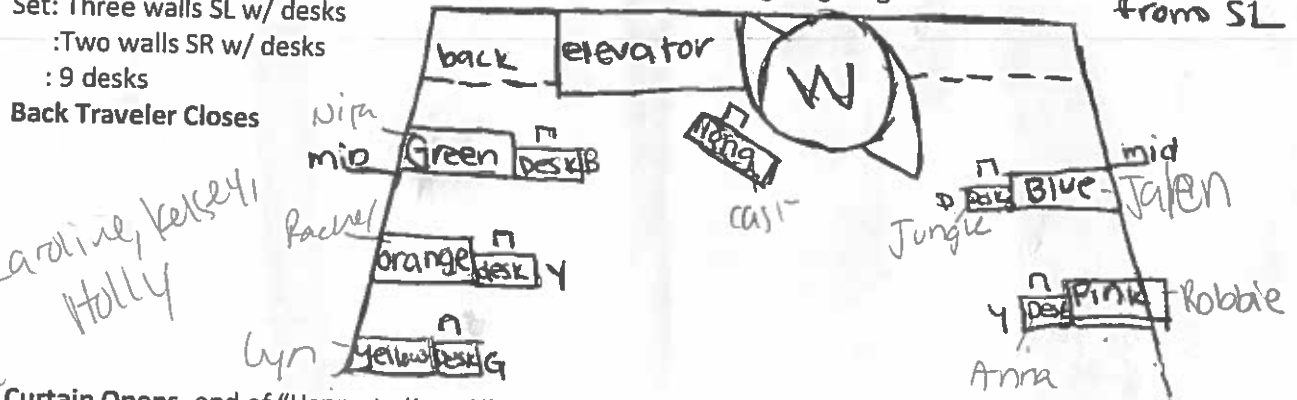

Curtain Opens- end of "Happy to Keep His Dinner Warm"

Pg. 12 Secretary Pool (for Sc. 3)

Red Curtain Closes: Smitty-"The future Mrs. Finch is in for some lonely nights"

Back traveler opens

Strike: Three walls SR

: Two walls SL

Set: All 9 desks with chairs

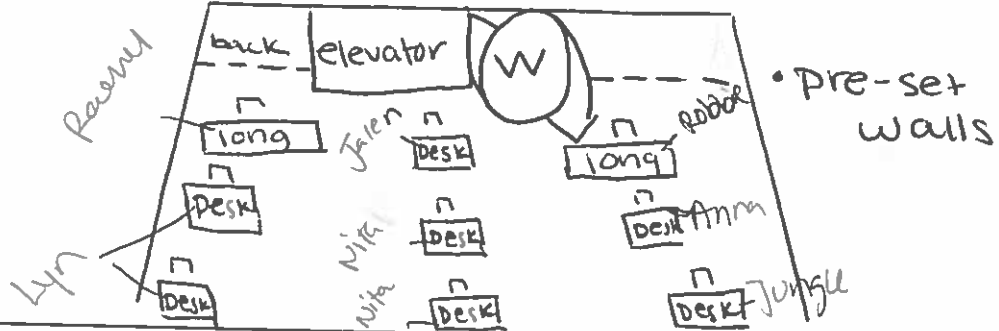

Pg. 16 Executive Floor

Red Curtain Closes: Bud-"Coffee!"

Strike- SL long desk and 2 desks with chairs

Set: Walls with desks

: SR long desk against unit

Traveler closes

Curtain opens: Book- "You are forearmed"

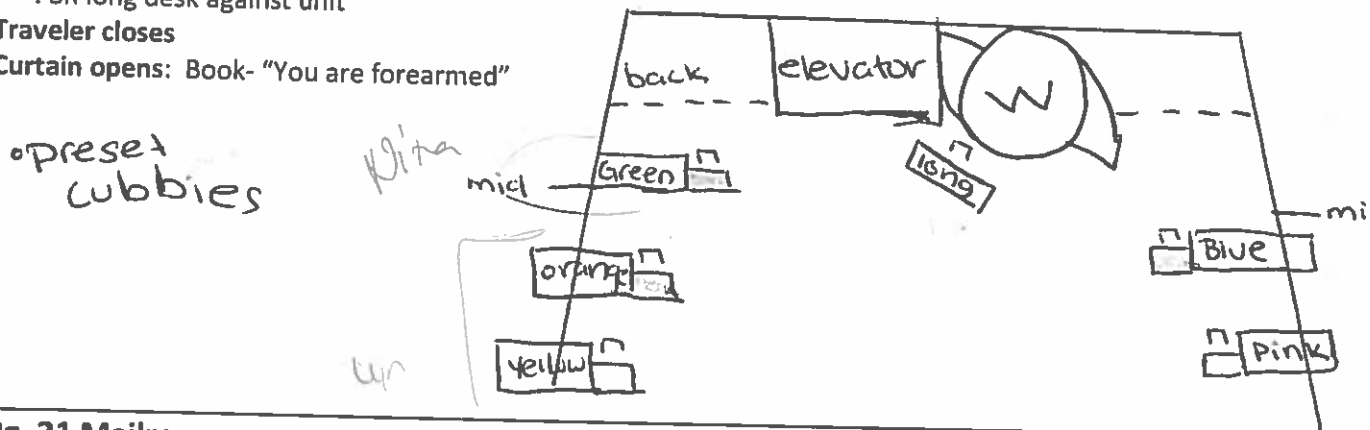

Pg. 21 Mailroom

Curtain Closes: Smitty-"A business man"

Strike: Desks and walls

Set: Cubbies from SR

: Mailroom desk from SL

: Trash can

: SR long desk with executive chair

Mid traveler closes

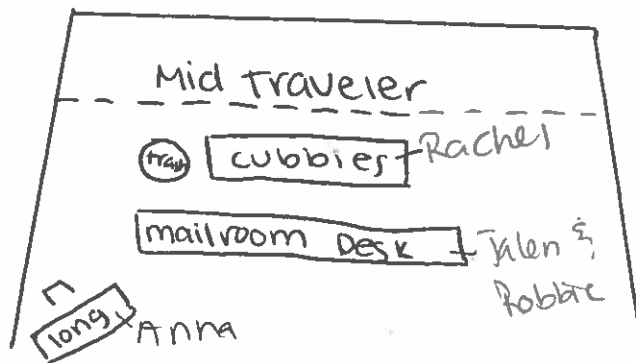

Curtain Opens to reveal Bud

Curtain closes to cover Bud- Bud: "You know, a real rat!"

Curtain opens- Biggley knits

Pg. 32 Outer Office

Cue: Everyone- "Gatch? Gatch. Gatch. Gatch."

Mid traveler opens

Mailroom desk exits out SL (to outside)

Cubbies exit USR (to outside)

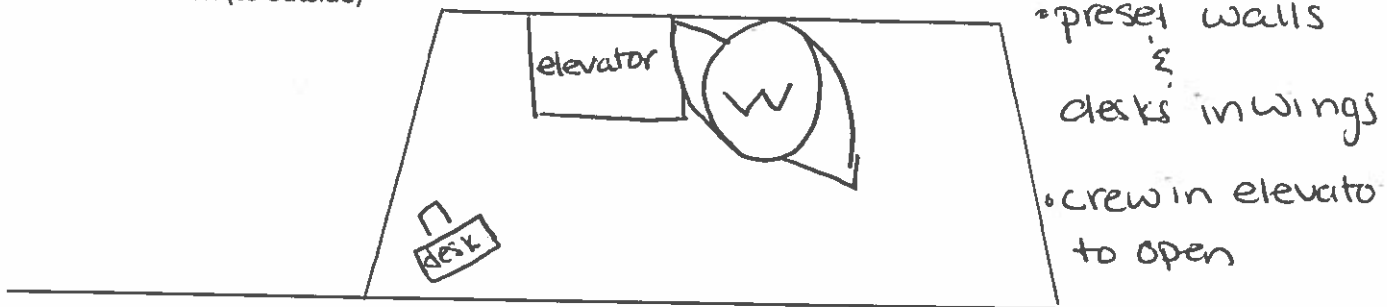

Sc. 5 In front of the curtain (executive floor scene change behind)

Curtain closes: Rosemary ♪ "Happy to keep his dinner warm till he comes wearily home." ♪

Long desk to UL

Walls and desks out

Before song starts,
cast strikes desks &
chairs. Crew must
strike all walls
At the same time.

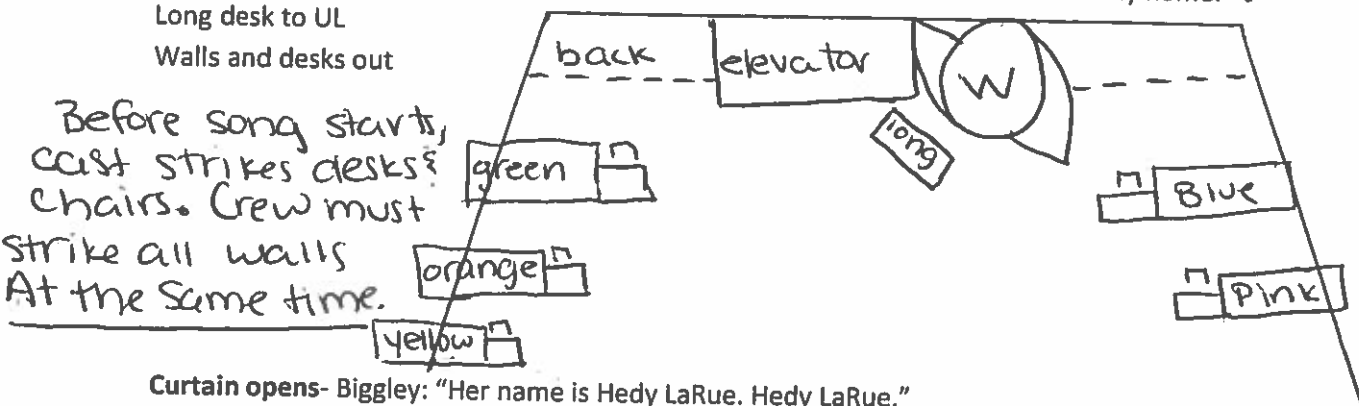

Curtain opens- Biggley: "Her name is Hedy LaRue. Hedy LaRue."

Sc. 7 Elevator Landing

Curtain closes: end of "Secretary is Not a Toy"

Back traveler opens

Strike: walls

Elevator comes downstage

Mid traveler closes

• Pre Set walls
desks in wing

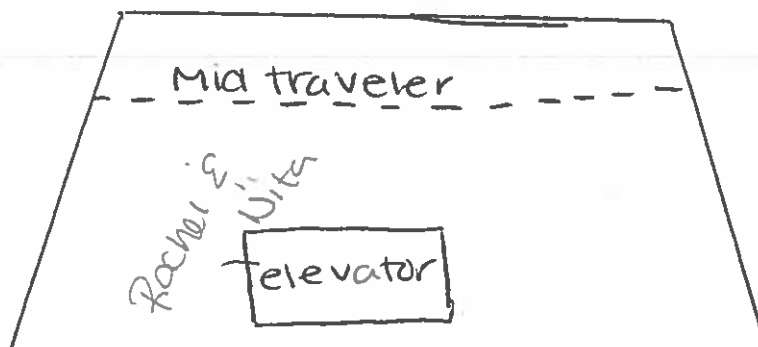

Elevator spins 180- music starts

Elevator spins 180- Chorus sings "Well it's been a long, been a long, been a long, been a long day."

Sc. 8 Outer Office

*walls square side
desks brown side

Curtain closes end of "Been a Long Day (Reprise)"

Move elevator to SR

Set: SR gold wall (sq) and desk(brown side)

: SL walls(sq) and 2 desks (brown side)

: Black rolling chairs

• preset Orange sq. wall
SR

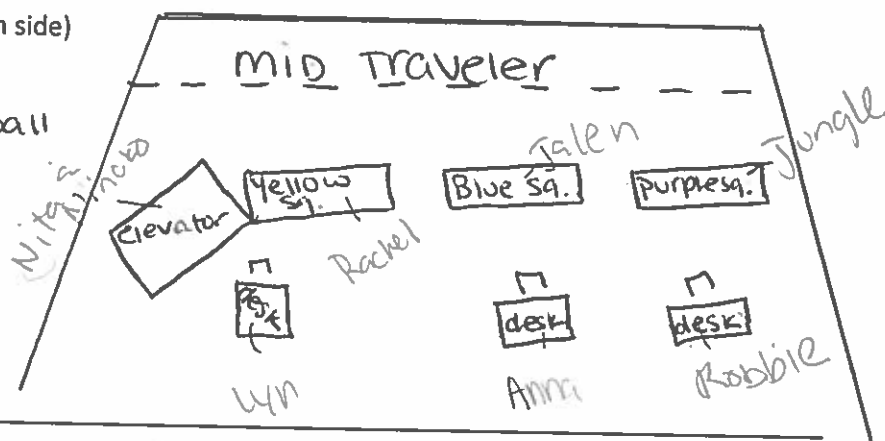

Sc. 9 Finch's First Office

Curtain closes: 1st scrub woman: "I'd say Vassar"

Mid traveler opens, Elevator US, Mid traveler closes

Orange wall from SR

Brown chair from SL

Strike 3 desks

Set long desk from SL

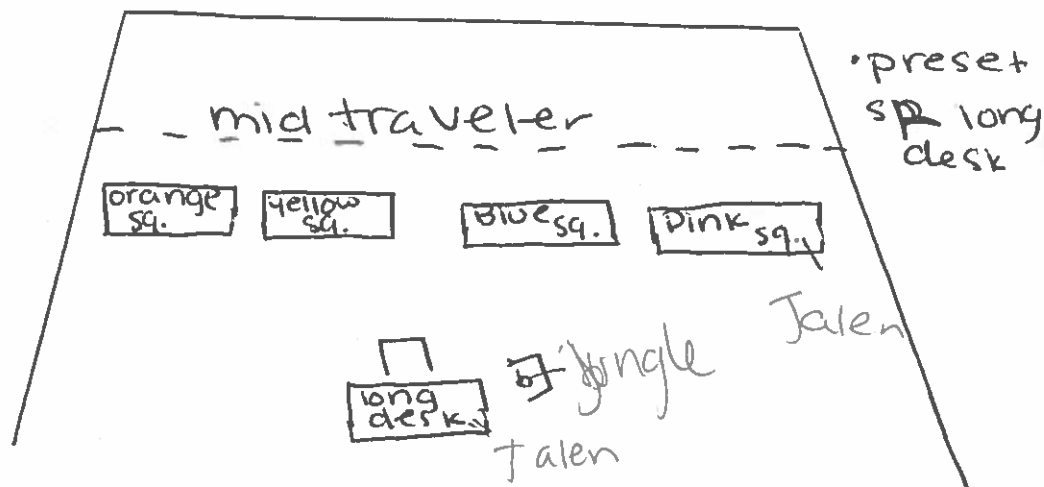

Sc. 10- Plans and Systems Office

Curtain closes-Hedy: "Okay, Charlie"

Spin flats around, purple @ C (Gatch's name) [desks together]

Strike orange flat

Add long desk from SR

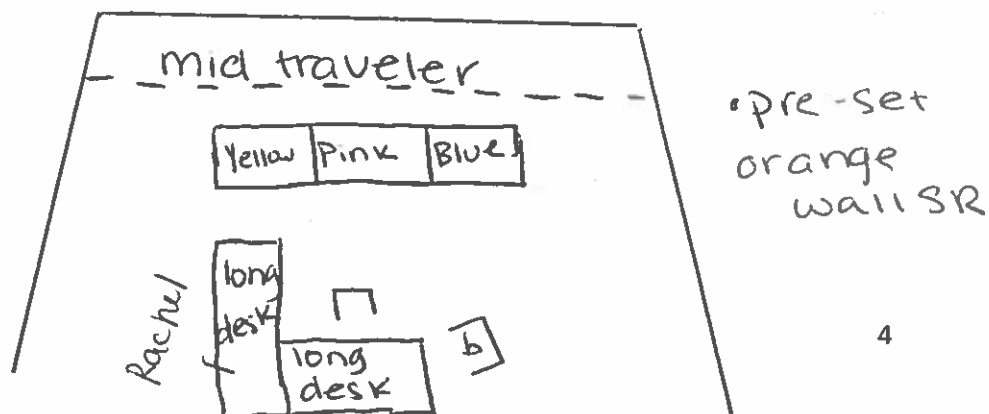

Pg. 69

Blackout

Switch Gatch sign to Finch

Sc. 11 Corridor in Wicket building

Curtain closes-Finch: "On of our out of town offices...Venezuela."

Desks struck to their respectable sides

Flip walls to square sides, add orange from SR and separate

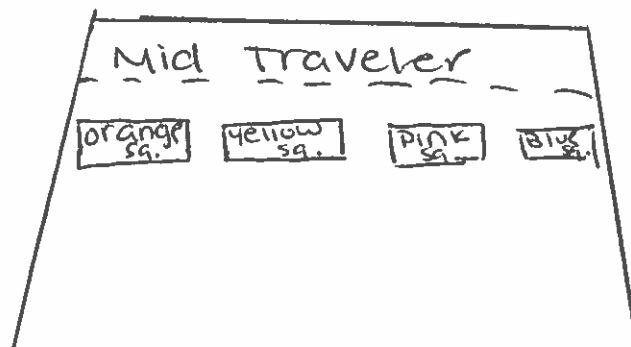

• pre-set
Paris original

Sc. 12 The Roof

Curtain Closes: Song begins

Mid traveler opens

Walls move upstage

Block and stairs on from SR

Bar & table with chairs on from SL

Terraces preset for curtain to open

★ Quick change
Hanna★

★ Block & stairs
↳ Blue fabric
upstage★

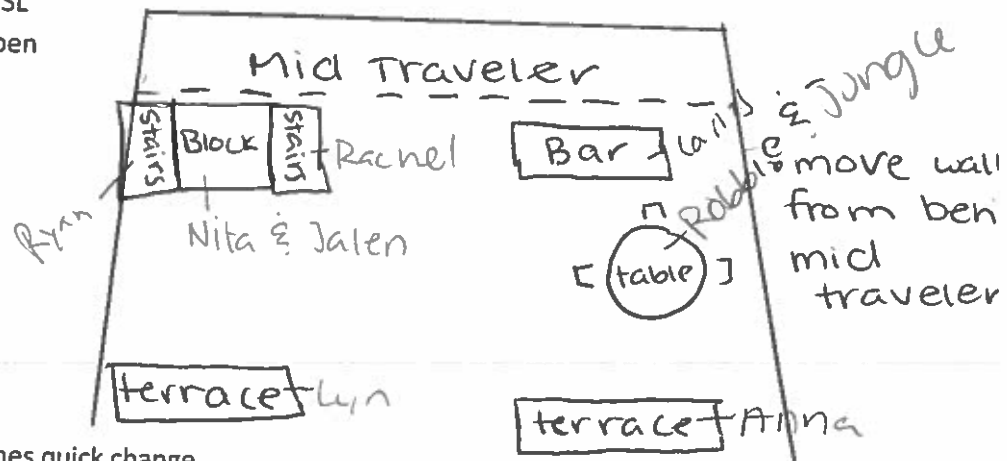

Curtain opens when Hanna finishes quick change

Sc. 13- Elevator landing

Curtain closes- Smitty: "Bud you must have heard the rumor" (and after terraces pulled back)

Open Mid traveler

Strike table and bar on SL

Strike stairs and block on SR

Spin unit

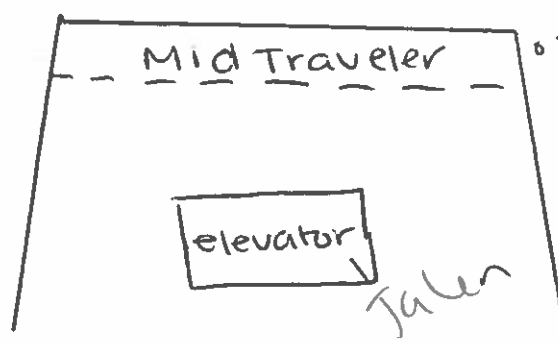

• Pre-set Biggley's
Office

- couch, desks
- green flat p'
5

(same as above)

Bring elevator down stage
Close mid traveler

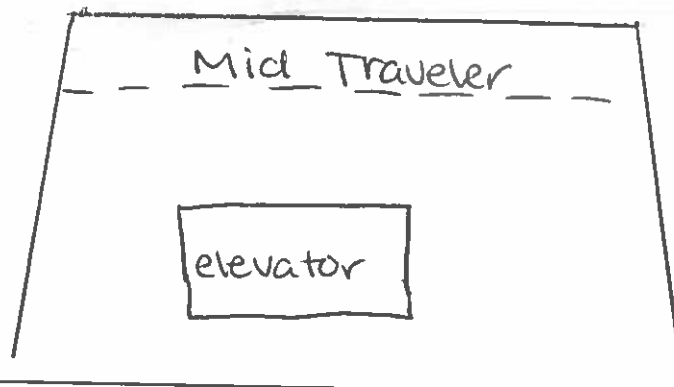

Sc. 14 Biggley's office

Curtain closes: Bud: Salsa "Ole!"

Mid traveler opens

Spin unit and push elevator back to crooked (**Brakes in elevator**)

Long desks in "L" with executive chair

Couch DL

Green wall DR

Close back traveler to elevator and unit

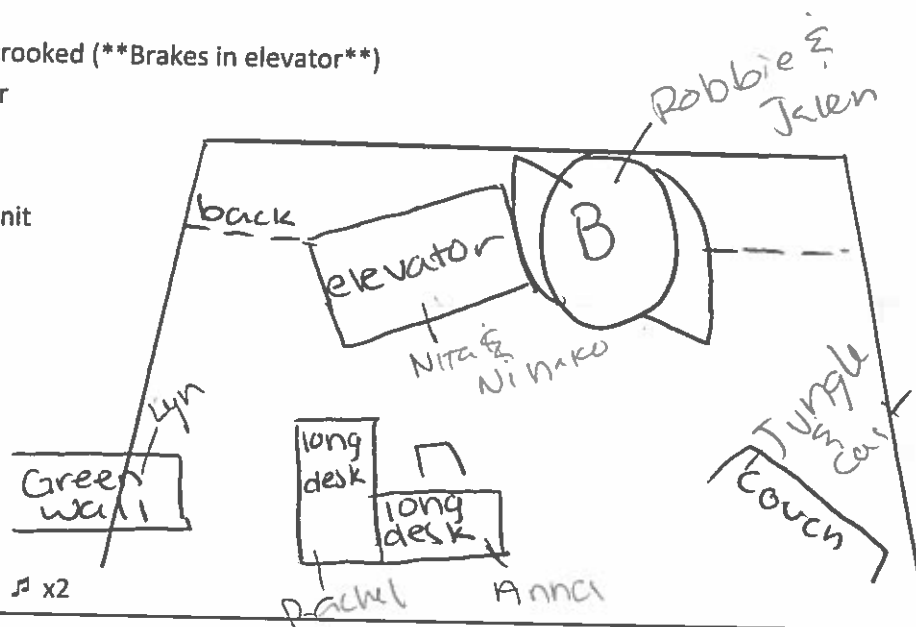

Curtain closes- Bud: ♪ "I will return!" ♪ x2

INTERMISSION

Open back traveler

Spin around unit and push elevator flat

Shut back traveler

Set desks and chairs

Outside: scaffolding, mailroom, table/cart, round table with white chairs, block, stairs, terraces

Bring in: sink, Cubbies (take shelves out), treasure chest, black bench, white benches

Onstage

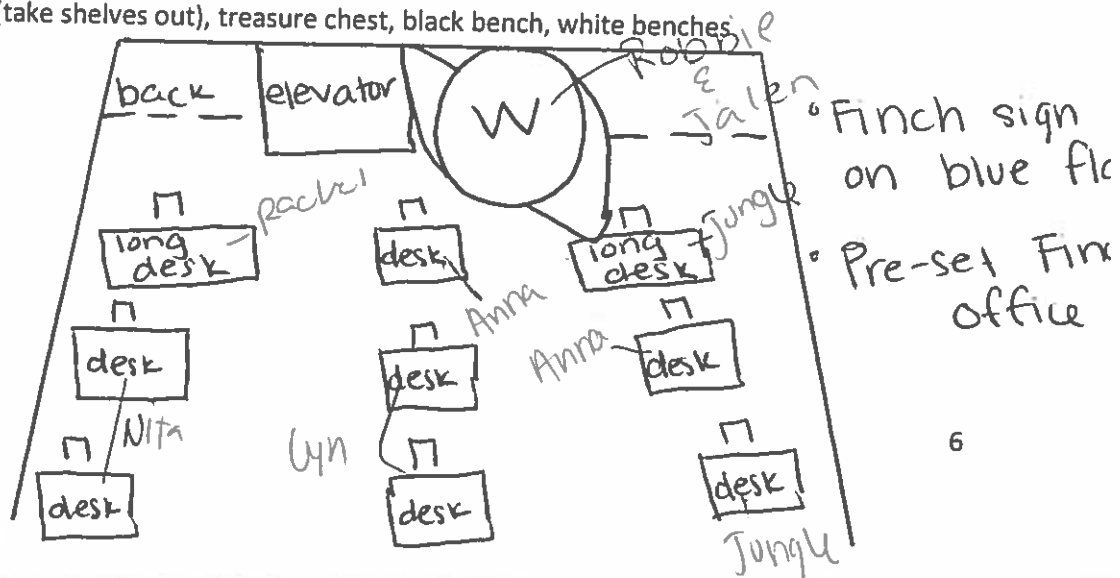

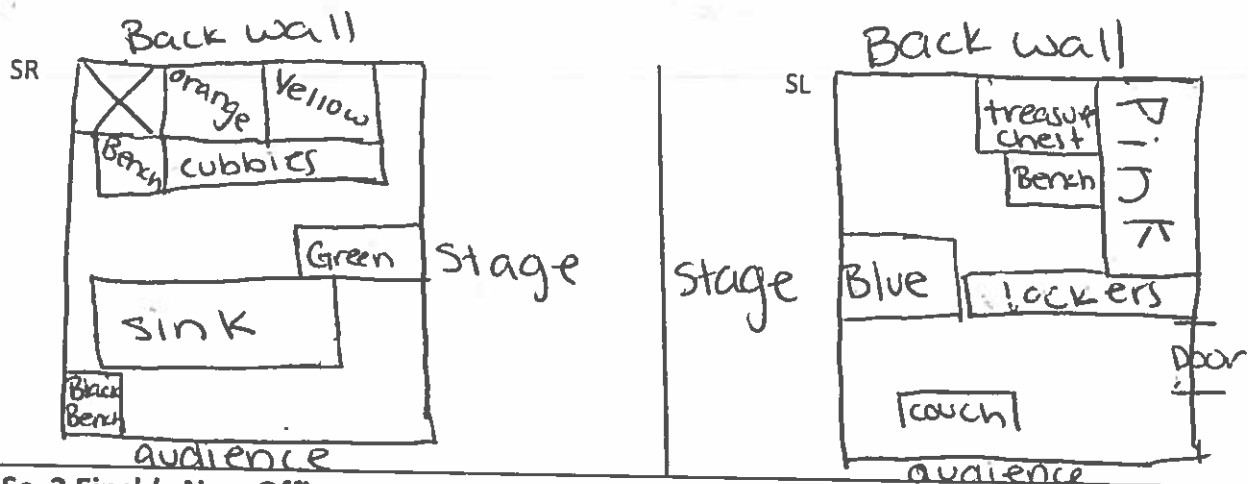

Sc. 2 Finch's New Office

Curtain closes-All: ♪ "hallelujah!" ♪

Strike all desks and chairs but the long ones (Long into "L")

Executive chair on

Brown chair from SL on

Green and blue walls (plain with Finch's name)

Mid traveler closes partially behind flats

Open back traveler



Sc. 3 Biggley's Office

Curtain Closes- Rosemary: End of "Happy to Keep His Dinner Warm (Reprise)"

Mid traveler opens

Strike blue wall, Green wall to DR

Spin unit

Elevator crooked

Couch on from SL

Brown chair off

Shut back curtain

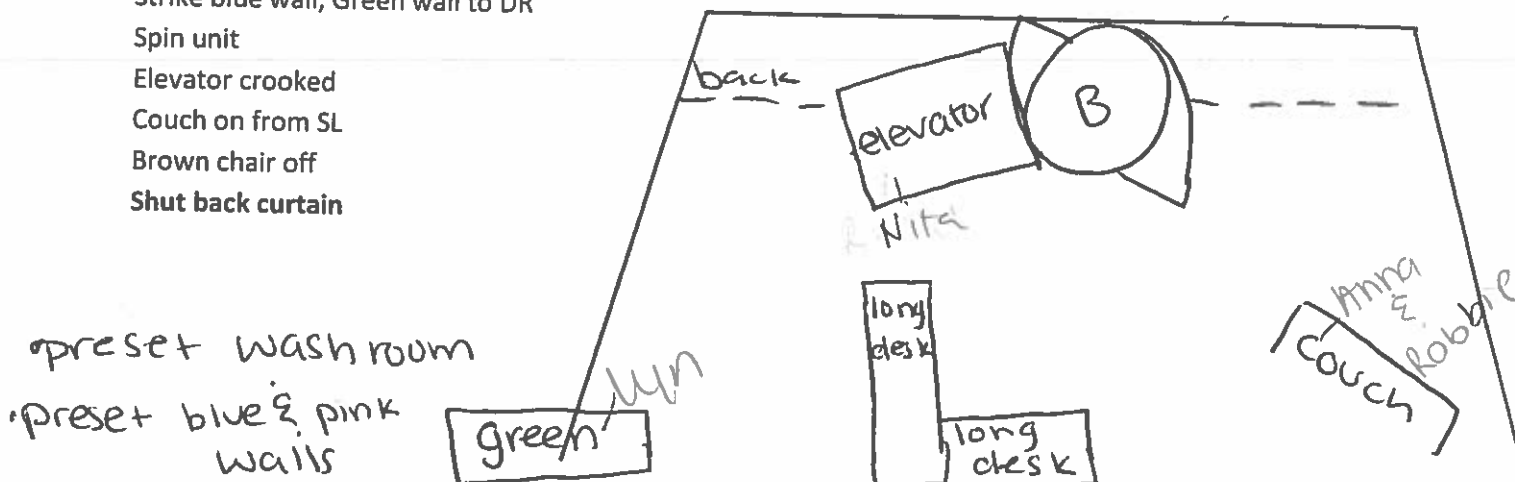

Sc. 4 Washroom

Curtain Closes: Nick falls off chair

Back traveler opens

Spin unit and move SL

Strike couch and desk L

Strike desk and wall R

Set Bench, cubbies, and sink from SR

Set bench and lockers from SL

Blue and Purple wall at C behind mid

Mid traveler closes to walls

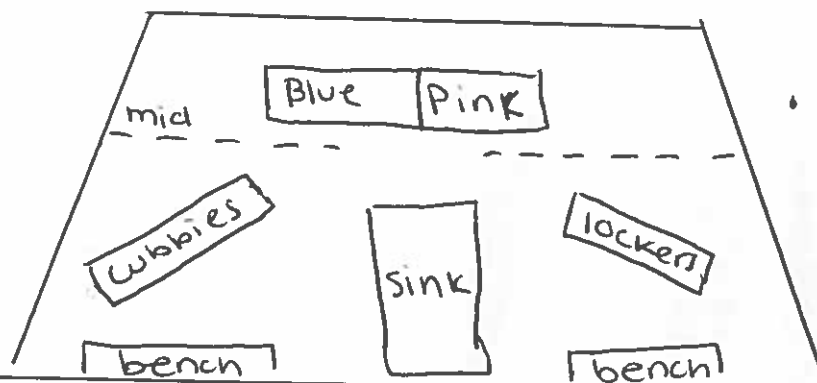

• preset board room

• executive chair to SL

Sc. 5 Boardroom

Curtain Closes-Finch: ♪ "I believe in you" ♪ x2 (After benches are struck)

Mid traveler opens, cubbies spun around and pushed US

Sink off R (to outside)

Mid traveler closes

Desks onstage with chairs (upstage so curtain doesn't hit)

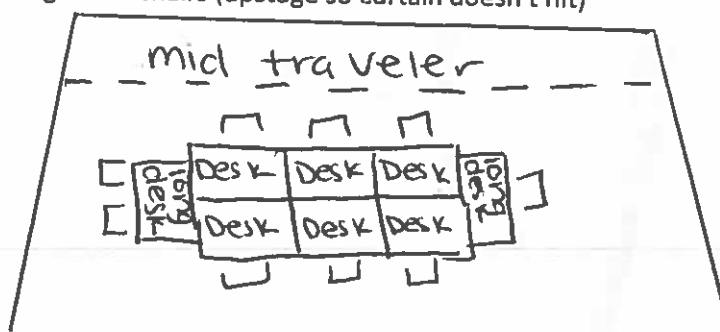

• Pre set TV show

• cubbies w/ gold

Sc. 6 Television show

Curtain closes: All: "We like it!" (Easel struck)

Mid traveler opens

Cubbies with gold come down

Mid traveler closes

Strike desks and chairs (SL desk and chair DSL)

Set treasure chest (SL) and black bench (SR)

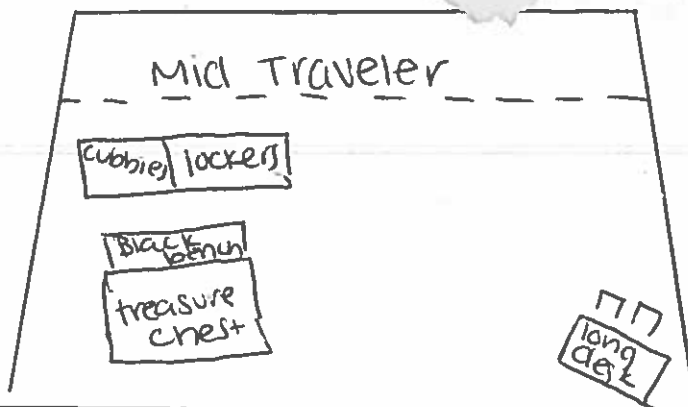

• preset outer office
 ↳ elevator ready, desks
 in wings, back traveler
 open

Sc. 7 Wicket Outer Office

Curtain closes- After Hedy reveals where treasure it and Wickette girls: "The first clue....." (DSL desk struck first)

Strike Bench (R), Treasure Chest (outside L), Lockers (Outside L), Cubbies (R) elevator slightly crooked.

Open Mid Traveler, spin unit and move elevator flat

Shut back traveler to unit and elevator

Set up long desk and short desk with chairs from SR, 2 desks from SL

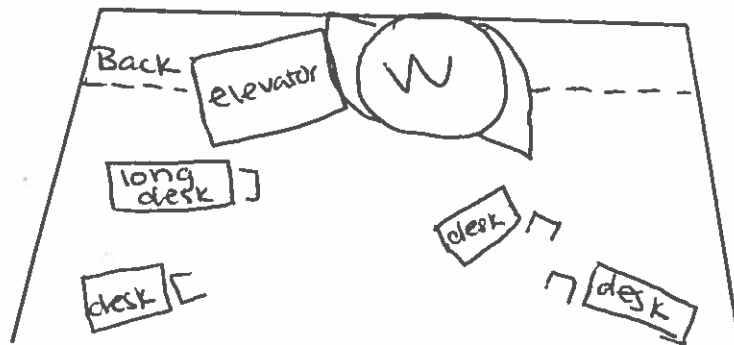

• crew in elevator

Sc. 8 Elevator Landing

Curtain slowly closes- Rosemary: "Ponty!"

Strike USC desks

Elevator moves forward to C (meet Red curtain)

Close Mid traveler

Strike desks and chairs

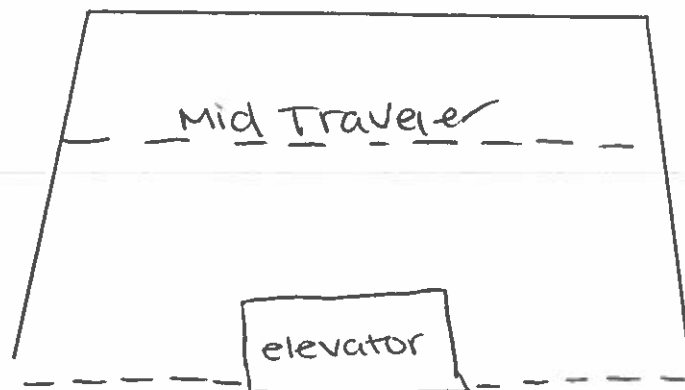

• preset
 desks &
 couch

Sc. 9 Biggley's Office

Curtain closes- Bud: "If I could only be sure."

Open mid traveler; spin unit and push elevator to crooked

Close back traveler

Set desks in "L"

Set couch from SL, green flat from SR

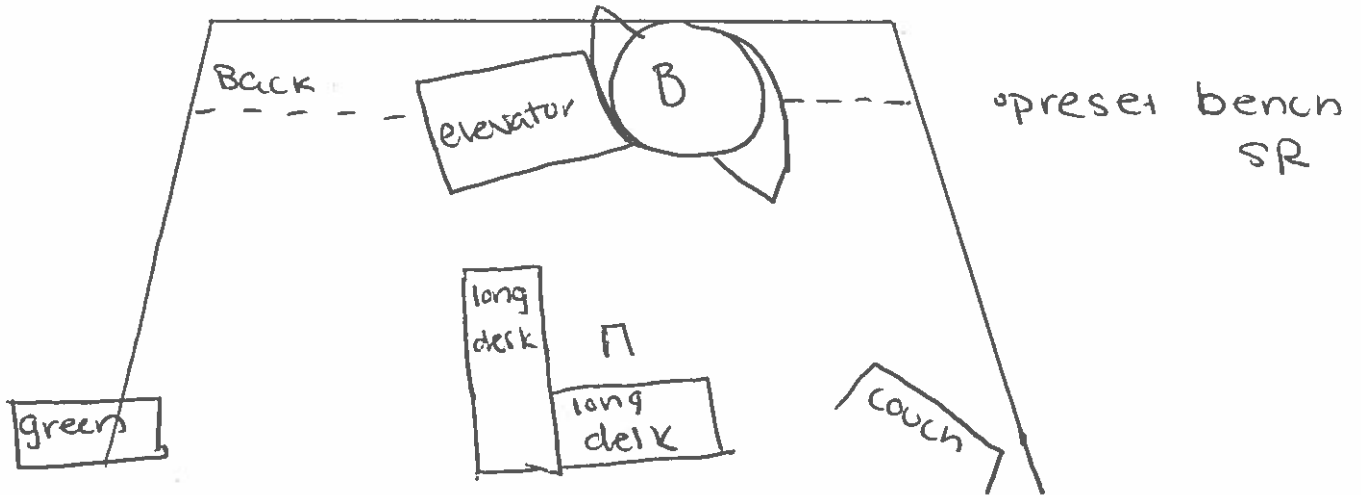

Sc. 9A In front of Curtain (Sc. 10- outer office behind)

Curtain closes: End of "Brotherhood of Man"

Open back traveler

Spin unit

Close back traveler

Strike couch

Long desk to DSR with black bench

Curtain opens- after Bud is dragged off

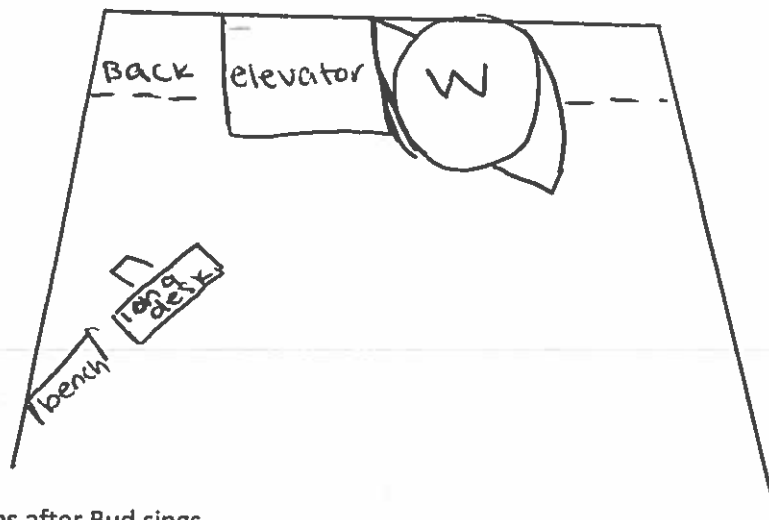

Curtain Closes after Bud sings

END OF SHOW!